



PlumbMaster, Inc.

NEW PRODUCT

SLOAN OPTIMA plus SENSOR MODULE COMPONENT PARTS

• For G2 Optima Plus® Flushometer Only (Introduced May, 2003)

The G2 OPTIMA Plus® builds on the success of the original product and offers many technological advancements to further improve on performance and reliability expected of sensor operated plumbing. In addition to a new aesthetic design, the G2 OPTIMA Plus features a new state-of-the-art electronic and optical package and a unique Solenoid Operator.

The G2 OPTIMA Plus® replaces the original OPTIMA Plus® product, which was phased out of production in mid 2003.

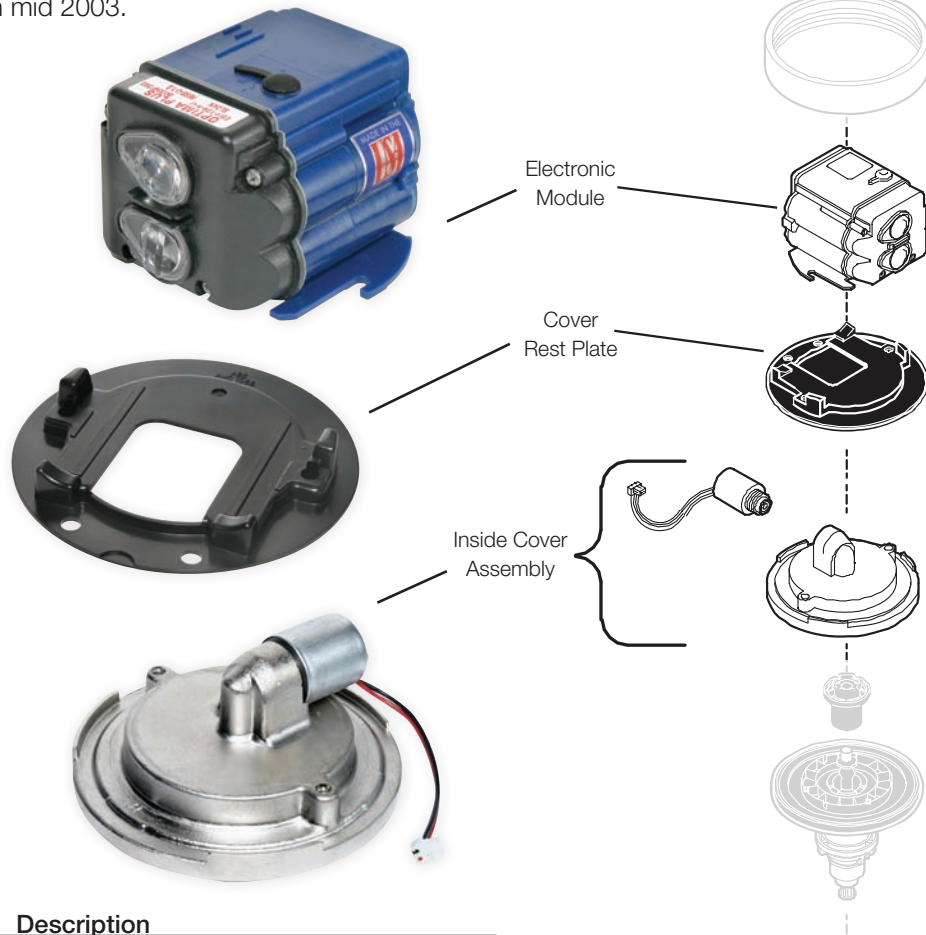

Cat. No.	OEM Ref.	Description
71076	EBV-129-A-C G2	Electronic Module — Water Closet
71077	EBV-129-A-U G2	Electronic Module — Urinal
71079	EBV-134	Cover Rest Plate
71078	EBV-145-A	Inside Cover Assembly (includes solenoid)