



**PlumbMaster, Inc.**

**NEW PRODUCT**

**REPLACE-IT™**  
**ADJUSTABLE DRAIN STRAINER**

- 12 or 14 Gauge Annealed Stainless Steel
- Replace those Old Rusted or Broken Cast Iron Strainers or Bar Grates
- Adjustable Screw Clips for a Wide Range of Openings
- Place Over Drain Opening and Slide Clips Outward to Contact Drain Walls
- Tighten Clip Bolts

**Cat. No. 52961** 7-1/4" Dia. for 3-1/4" to 6-3/4" Drain Openings, 14 GA

**Cat. No. 52962** 9-1/4" Dia. for 5-1/4" to 8-3/4" Drain Openings, 12 GA



**Installation**

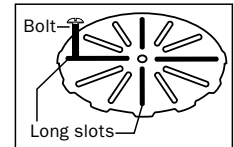

From the top of the strainer, insert bolt through one of the four long slots in the strainer.

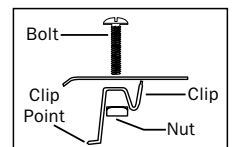

Slip bolt through hole in clip, and loosely thread into the nut. Repeat for remaining three clip sets.

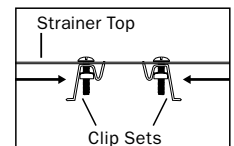

After assembly, slide all four clip sets toward the center of the strainer.

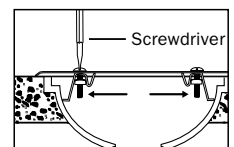

Install strainer in the drain opening. Slide the clip sets outward until they contact the drain. Tighten bolts.