

FINALE

PULL-OUT-SPOUT KITCHEN FAUCET BY: WOLVERINE BRASS

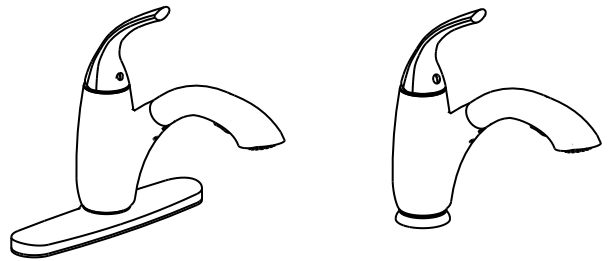

85035 - CHROME
8503504 - BRUSH NICKEL
8503505 - OIL RUB BRONZE

FIGURE (1)



FIGURE (2)

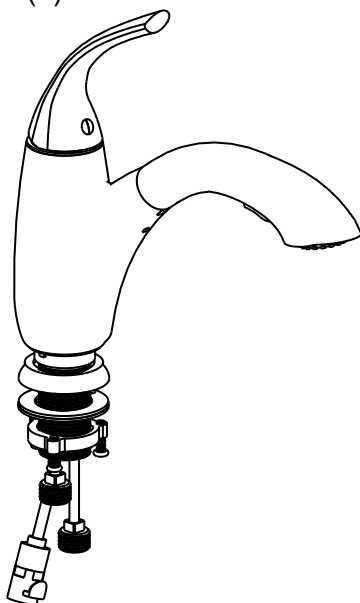

INSTALLATION INSTRUCTIONS:

THREE HOLE INSTALLATION (FIGURE 1)

- 1.) Remove Single Hole Mount Flange from faucet.
- 2.) Assemble "Deck Plate" to faucet.
- 3.) Assemble "Putty Plate" to faucet.
- 4.) Position faucet on sink.
- 5.) From underside of sink, assemble "Mount Washer & Nut" and "Stud Nuts".
- 6.) Assemble "Braided Spray Hose" to "Hose Quick Connect". CAUTION: Make sure hose is properly engaged and secure in faucet hose quick connect.
- 7.) Assemble hose weight to braided spray hose.
- 8.) Assemble water supply lines to faucet.
CAUTION: Use wrench or pliers to hold faucet inlet adapters when tightening supply line nuts to prevent twisting copper tubing or damaging solder joints.
- 9.) Remove spray wand from faucet and flush water through faucet to remove any line trash.
- 10.) Assemble spray wand and run water through faucet while checking for leaks at all connections.

SINGLE HOLE MOUNT INSTALLATION (FIGURE 2)

- 1.) Assemble "Single Hole Mount Flange" onto faucet.
- 2.) Assemble faucet to sink following steps (4) through (10) from above.