

# **PARAMOUNT**

---

## **SP1060 / SP1061 SERIES**

### **SINGLE ACTING SPRING HINGES**

- Non-handed
  - Base material: SP1060 is steel and SP1061 is stainless steel
  - High grade plated finishes
  - Washer bearings
  - Easily adjusted spring tension
  - Quality wood screws and undercut machine screws included.
  - Spring tensioner tool included
  - UL listed
  - Standard template hole pattern conforming to ANSI standard A156.7
- 



---

The SP1060 & SP1061 series single acting spring hinges are available in a variety of sizes and finishes. Made from the highest quality materials. These hinges are recommended by door hardware specialists for moderate to high traffic wood or hollow metal door applications. These spring hinges are recognized for value while delivering lasting performance when used in conjunction with ball bearing template butt hinges.

---

# SP1060 / SP1061 SERIES HINGES

## SPECIFICATION

All full mortise single acting template spring hinges shall be SP1060 / SP1061 series. SP1060 series spring hinges shall be made of select quality steel and high grade plated finishes. SP1061 series spring hinges shall be made of type 304 stainless steel and shall have 3 knuckles with washer bearings. Hinges shall have four square corners. Hinges shall be non-handed and supplied with spring tensioner and all necessary wood and undercut machine mounting fasteners.

## SELECTION GUIDE

MODEL NUMBER	SIZE	FINISH	MACHINE SCREWS	WOOD SCREWS	QTY PER BOX / CASE	CASE LBS / KG
SP1060-3535	3 1/2 (88.9) x 3 1/2 (88.9)	P*, 3*, 26D	#10-24 x 1/2 (12.7)	#9 x 3/4 (19.1)	2 / 48	29.5 / 13.4
SP1061-3535*		32D*		#10 x 1 (25.4)		40.0 / 18.2
SP1060-44	P*, 3, 26D	#12-24 x 1/2 (12.7)				#12 x 1 1/4 (32.0)
SP1061-44*	32D*		4 1/2 (114.3) x 4 1/2 (114.3)	P, 3*, 26D		61.7 / 28.0
SP1060-454*	P*, 3*, 26D*					
SP1061-454*	32D*					
SP1060-4545	P, 3*, 26D					
SP1061-4545	32D					

ANSI equivalence for reference only: steel - K81071F, stainless steel - K51071F

ORDERING EXAMPLE: **SP1060** | **-4545** | **-26D**  
SERIES      SIZE      FINISH

## SIZE CHART

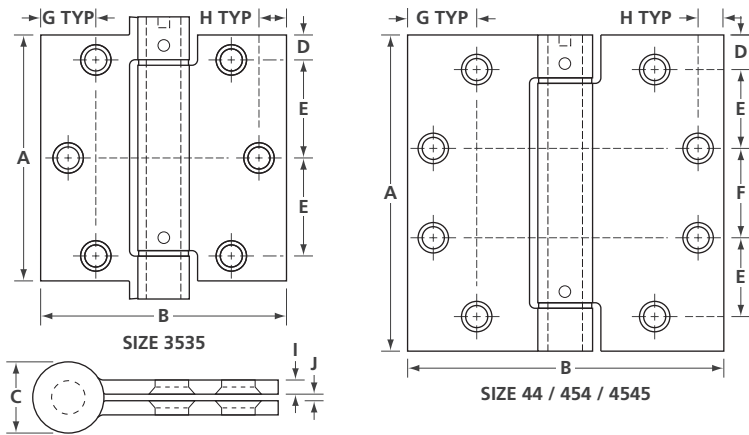

### APPLICATION GUIDELINES

SIZE	MAX DOOR WEIGHT LBS / KG	SPRING HINGES (PCS)	BUTT HINGES (PCS)
3535	50.0 / 22.7	2	1
	70.0 / 31.8		N/A
	90.0 / 40.9	3	N/A
44	60.0 / 27.2	2	1
	85.0 / 38.6		N/A
	110.0 / 50.0	3	N/A
454	70.0 / 31.8	2	1
	115.0 / 52.3		N/A
	150.0 / 68.2	3	N/A
4545	70.0 / 31.8	2	1
	115.0 / 52.3		N/A
	150.0 / 68.2	3	N/A

SIZE	A	B	C	D	E	F	G	H	I	J
3535	3 1/2 (88.9)	3 1/2 (88.9)	45/64 (18)	11/32 (9.0)	1 13/32 (35.4)	N/A	11/16 (17.5)	11/32 (9.1)	0.1 (2.5)	1/16 (1.6)
44	4 (101.6)	4 (101.6)	25/32 (19.6)	1/2 (13.0)	1 (25.5)	31/32 (24.6)	3/4 (19.1)	3/8 (9.5)	0.134 (3.4)	
454	4 1/2 (114.3)	4 1/2 (114.3)		1/2 (12.9)	1 1/8 (28.6)	1 7/32 (31.3)	1 (25.4)			
4545										